

CC-Link IE Field Slave IP

Compatible with Mitsubishi Electric CP220



Features

- Supports CC-Link IE Field and Intelligent device station
- Supports Cyclic transmission and Transient transmission
 - RX/RX = 2048 bits each, RWR/RWw = 1024 words each
- Light CPU load

Merits of the IP embedded in FPGA

- Integrate user logics in addition to CP220 equivalent functions
- Implements various industrial protocols other than CC-Link IE Field on the single FPGA
- Provides a platform for multi low-volume applications
- Simple software migration from existing CP220

CC-Link IE Field IP Core Topology Check Demo

CC IE Field Diagnostics



“Remote I/O”
Mitsubishi Electric:
(L61P+ L26CPU+ LJ71GF11-T2)

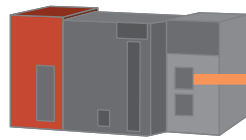

Macnica:
Sodia - Cyclone V ST SoC Board

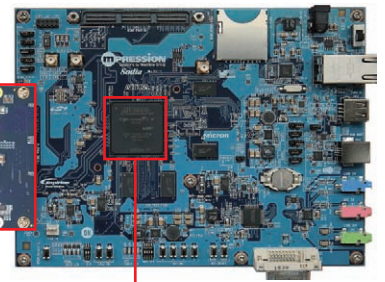

Terasic:
HSMC-NET

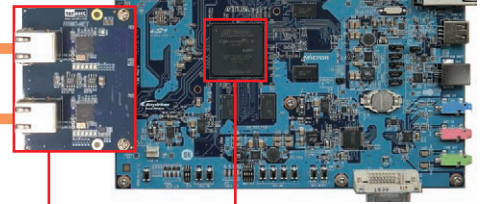

“Master”
Mitsubishi Electric:
(Q00UJCPU_V+ QJ71GF11-T2_V)

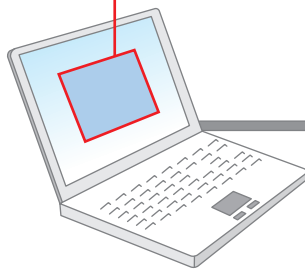
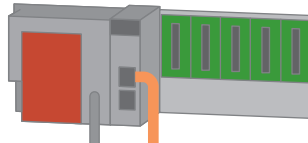

“Monitor tool”
Mitsubishi Electric: GX Works2

